



HU606 - This is a single-level, ultra luxury unit offering the opportunity to combine hospitality and/or display functions in separate areas, the large windows give an environment which is open but protected. With a large 3 x 2 metre rear extendable pod and front stage this unit will act as a real magnet for visitors wherever it appears.

The interior can be adapted to accommodate more or less bench seating, there is a kitchenette with serving bar and there are also storage areas to keep those essentials out of sight. Large internal and external display areas make it an ideal trailer to attract your customers directly onto the stand.

Features

- Electric kitchen with fridge
- Nose cone storage and worktop
- Massive hospitality rear pod
- Lots of seating
- Furniture options
- Large storage areas
- Sliding patio doors with large stage
- Windows to side of doors

Size aspect

- 5x5 car park spaces
- Including towing frame 7450mm

Technical Specification

- Body length (overall) 6120mm
- Trailer length with towing frame 7790 mm
- Width (set up) 5650mm
- Height 3200mm
- Headboard and canopy are full length

Internal Sizes of Trailer.

- Main floor length 5840mm
- Width 1900mm (with pod 3600mm)
- Height 2250mm
- Door height 1830mm

The Mobex Service.

When you hire a trailer from Mobex

1. It is made ready to your exact requirements including any graphics and accessories.
2. We arrange the delivery with the event organisers and your other contractors.
3. We mow any grass (if required) and correctly position on the plot.
4. Set up all furniture and accessories. Secure as required ready for you to just "Turn up and present".
5. Pack up and collect at end of the event.

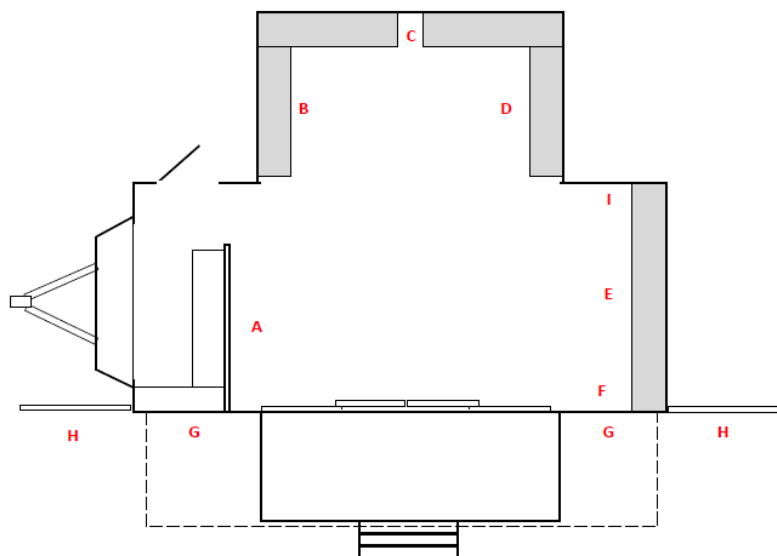

Graphic Panels (width x height) mm

A (Counter Front) – 1200 x 1200 B – 1700 x 1300

C – 2980 x 1300 D – 1700 x 1300

E – 1700 x 1300 F – 1370 x 1600

G – 1210 x 1820 H – 1210 x 1820

I -- 1650 x 1300 Headboard – 5860 x 470

Flags are an optional extra – Speak to us for details